

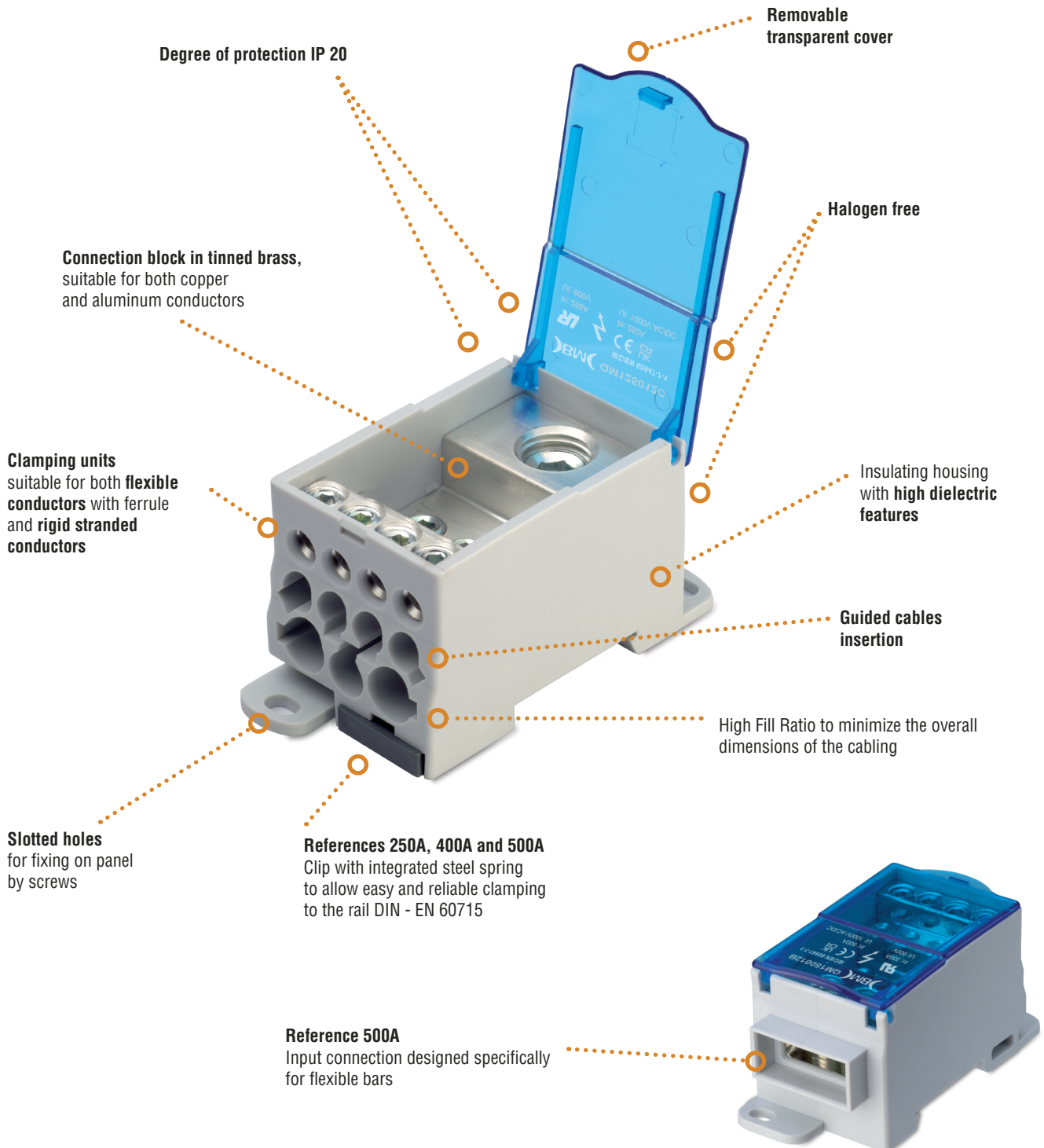

DISTRIBUTION BLOCKS



1-WAY DISTRIBUTION BLOCKS 80A, 125A, 160A, 250A, 400A, 500A



Degree of protection IP 20

Removable transparent cover

Connection block in tinned brass, suitable for both copper and aluminum conductors

Halogen free

Clamping units suitable for both flexible conductors with ferrule and rigid stranded conductors

Insulating housing with high dielectric features

Guided cables insertion

High Fill Ratio to minimize the overall dimensions of the cabling

Slotted holes for fixing on panel by screws

References 250A, 400A and 500A
Clip with integrated steel spring to allow easy and reliable clamping to the rail DIN - EN 60715

Reference 500A
Input connection designed specifically for flexible bars

HALOGEN FREE

Halogen free to install the distribution block everywhere



Removable transparent cover



Compliant to harmonized standard IEC/EN 60947-7-1



Compliant to standard UL 1059

DISTRIBUTION BLOCKS • MODULAR • 1-WAY • 80A, 125A, 160A, 250A, 400A, 500A

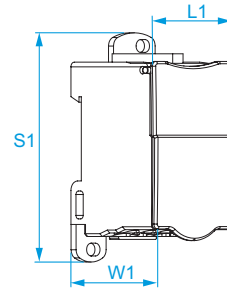

INSULATING HOUSING: polyamide (PA 6.6) UL 94 V0

COVER: polycarbonate (PC)

CONNECTION BLOCK: tinned brass

SCREWS: galvanized steel

RATED INSULATION VOLTAGE: 1000V AC/DC (IEC), 600V AC/DC (UL)

DEGREE OF POLLUTION: 3

ACCORDING TO STANDARDS: IEC/EN 60947-7-1; UL 1059

Code	Rated Current (In)	Connections	IEC Conductor	UL Conductor	IEC Torque	UL Torque	IEC Rated impulse withstand voltage (Uimp)	IEC Short-Time Current (Icw)	IEC Peak Current (Ipk)	L1	W1	S1	
	A	mm x Nr	mm ²	AWG/MCM	Nm	Lb in.	kV	kA	kA	mm	mm	mm	
QM108007C	80 (IEC) 85 (UL)	ø 6.8 x 1	6 - 16	16 - 4	3.5	19.5	12	3	22	27	47	66	5/5
		ø 6.8 x 2	2.5 - 16	16 - 4	3.5	19.5							
		ø 4.5 x 4	2.5 - 6	16 - 8	1.2	10.6							
QM112508C	125 (IEC) 150 (UL)	ø 10 x 1	10 - 35	8 - 1/0	8.5	57	12	4.2	30	29	46	76	5/5
		ø 6.8 x 1	6 - 16	14 - 2	3.5	31							
		ø 6.8 x 6	2.5 - 16	14 - 4	3.5	31							
QM116008C	160 (IEC) 200 (UL)	ø 12.3 x 1	10 - 70	8 - 3/0	8.5	75	12	11.8	30	29	46	76	5/5
		ø 6.8 x 1	6 - 16	14 - 2	3.5	31							
		ø 6.8 x 6	2.5 - 16	14 - 4	3.5	31							
QM125012C	250 (IEC) 255 (UL)	ø 15 x 1	35 - 120	6 - 250	19	168	12	24.5	51	47	50	97	3/3
		ø 9 x 2	6 - 35	10 - 1	4.4	39							
		ø 6.8 x 5	2.5 - 16	14 - 4	2.7	24							
		ø 6.1 x 4	2.5 - 10	14 - 6	2.7	24							
QM140012C	400 (IEC) 335 (UL)	ø 19 x 1	95 - 185	3/0 - 400	25	221	12	24.5	51	47	50	97	3/3
		ø 9 x 2	6 - 35	10 - 1	4.4	39							
		ø 6.8 x 5	2.5 - 16	14 - 4	2.7	24							
QM150012B	500 (IEC) 335 (UL)	[25x9] x 1	4-6x(15.5x0.8) 2-6x(20x1) 2-8x(24x1)	min 2x(20x1) max 8x(24x1)	13.5	120	12	24.5	51	47	50	97	3/3
		ø 9 x 2	6 - 35	10 - 1	4.4	39							
		ø 6.8 x 5	2.5 - 16	14 - 4	2.7	24							
		ø 6.1 x 4	2.5 - 10	14 - 6	2.7	24							



file n° E 70156

IP20

HALOGEN FREE

2 AND 4 WAYS DISTRIBUTION BLOCKS 40A, 100A, 125A

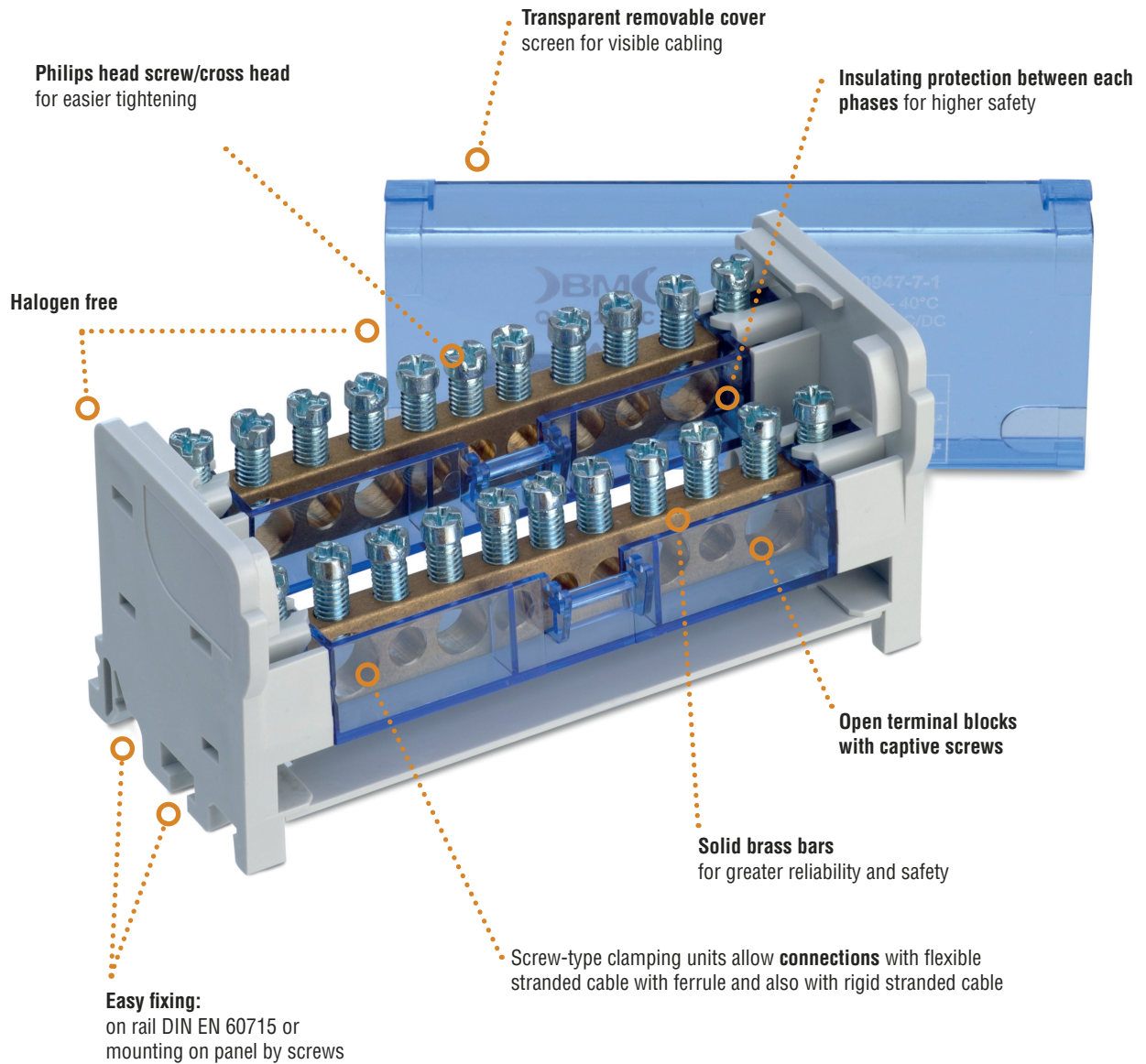

**HALOGEN
FREE**

Halogen free to install the distribution block everywhere



Solid brass bars for greater reliability and safety



Transparent cover screen for visible cabling



Compliant to harmonized standard EN 60947-7-1

DISTRIBUTION BLOCKS • MODULAR • 2-WAYS • 40A, 100A, 125A

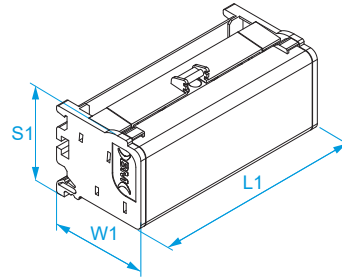

INSULATING HOUSING: polycarbonate (PC) UL 94 V0
INSULATED PROTECTIONS: polycarbonate (PC) UL 94 V0
CONNECTION BARS: brass
SCREW: galvanized steel

SELF-EXTINGUISHING: EN 60695-2-11 at 850 °C
AMBIENT TEMPERATURE: 40 °C
INSULATION VOLTAGE (Ui): 500 V
DEGREE OF POLLUTION: 3
ACCORDING TO STANDARD: IEC/EN 60947-7-1

Code	Rated Current (In)	Short-Time Current (Icw)	Peak current (Ipk)	Connections for way	Flexible conductor with terminal	Rigid stranded conductor	Torque	L1	W1	S1	
	A	kA	kA								
QM204017C	40	4.5	20	ø 6 x 2	4 - 10	6 - 16	2 - 3	140	50	47	1/1
				ø 4.3 x 15	0.75 - 4	1.5 - 4	1.2 - 1.5				
QM210007C	100	4.5	20	ø 7.5 x 2	6 - 16	10 - 25	2 - 3	70	50	47	1/1
				ø 5.3 x 5	1.5 - 6	2.5 - 6	2 - 3				
QM210015C	100	4.5	20	ø 8.5 x 2	10 - 25	10 - 25	2 - 3	140	50	47	1/1
				ø 5.5 x 7	1.5 - 6	2.5 - 6	2 - 3				
				ø 4.5 x 6	0.75 - 4	1.5 - 4	1.2 - 1.5				
				ø 9 x 1	10 - 25	10 - 35	2 - 3				
QM212507C	125	4.5	20	ø 7.5 x 1	6 - 16	10 - 25	2 - 3	70	50	47	1/1
				ø 5.3 x 5	1.5 - 6	2.5 - 6	2 - 3				
				ø 9 x 2	10 - 25	10 - 35	2 - 3				
QM212511C	125	4.5	20	ø 7.5 x 2	6 - 16	10 - 25	2 - 3	105	50	47	1/1
				ø 5.3 x 7	1.5 - 6	2.5 - 6	2 - 3				
				ø 9 x 2	10 - 25	10 - 35	2 - 3				
QM212515C	125	4.5	20	ø 9 x 2	10 - 25	10 - 35	2 - 3	140	50	47	1/1
				ø 7.5 x 2	6 - 16	10 - 25	2 - 3				
				ø 5.3 x 11	1.5 - 6	2.5 - 6	2 - 3				

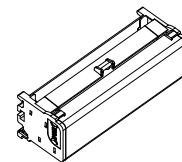
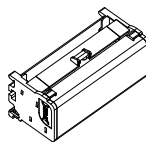
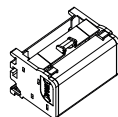

Rated Current (In)	4 MODULES (L=70 mm)	6 MODULES (L=105 mm)	8 MODULES (L=140 mm)
40 A	-	-	QM204017C
100 A	QM210007C	-	QM210015C
125 A	QM212507C	QM212511C	QM212515C

DISTRIBUTION BLOCKS • MODULAR • 4-WAYS • 40A, 100A, 125A

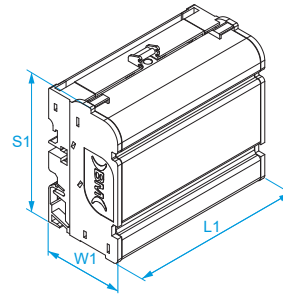

INSULATING HOUSING: polycarbonate (PC) UL 94 V0
INSULATED PROTECTIONS: polycarbonate (PC) UL 94 V0
CONNECTION BARS: brass
SCREW: galvanized steel

SELF-EXTINGUISHING: EN 60695-2-11 at 850 °C
AMBIENT TEMPERATURE: 40 °C
INSULATION VOLTAGE (Ui): 500 V
DEGREE OF POLLUTION: 3
ACCORDING TO STANDARD: IEC/EN 60947-7-1

Code	Rated Current (In)	Short-Time Current (Icw)	Peak current (Ipk)	Connections for way	Flexible conductor with terminal	Rigid stranded conductor	Torque	L1	W1	S1	
	A	kA	kA								
QM404013C	40	4.5	20	ø 6 x 2	4 - 10	6 - 16	2 - 3	105	50	87	1/1
				ø 4.3 x 11	0.75 - 4	1.5 - 4	1.2 - 1.5				
QM410007C	100	4.5	20	ø 7.5 x 2	6 - 16	10 - 25	2 - 3	70	50	87	1/1
				ø 5.3 x 5	1.5 - 6	2.5 - 6	2 - 3				
QM410011C	100	4.5	20	ø 8.5 x 2	10 - 25	10 - 25	2 - 3	105	50	87	1/1
				ø 5.5 x 5	1.5 - 6	2.5 - 6	2 - 3				
				ø 4.5 x 4	0.75 - 4	1.5 - 4	1.2 - 1.5				
				ø 8.5 x 2	10 - 25	10 - 25	2 - 3				
QM410015C	100	4.5	20	ø 5.5 x 7	1.5 - 6	2.5 - 6	2 - 3	140	50	87	1/1
				ø 4.5 x 6	0.75 - 4	1.5 - 4	1.2 - 1.5				
				ø 9 x 1	10 - 25	10 - 35	2 - 3				
QM412507C	125	4.5	20	ø 7.5 x 1	6 - 16	10 - 25	2 - 3	70	50	87	1/1
				ø 5.3 x 5	1.5 - 6	2.5 - 6	2 - 3				
				ø 9 x 2	10 - 25	10 - 35	2 - 3				
QM412511C	125	4.5	20	ø 7.5 x 2	6 - 16	10 - 25	2 - 3	105	50	87	1/1
				ø 5.3 x 7	1.5 - 6	2.5 - 6	2 - 3				
				ø 9 x 2	10 - 25	10 - 35	2 - 3				
QM412515C	125	4.5	20	ø 9 x 2	10 - 25	10 - 35	2 - 3	140	50	87	1/1
				ø 7.5 x 2	6 - 16	10 - 25	2 - 3				
				ø 5.3 x 11	1.5 - 6	2.5 - 6	2 - 3				

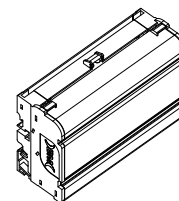
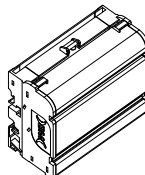
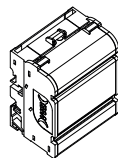

Rated Current (In)	4 MODULES (L=70 mm)	6 MODULES (L=105 mm)	8 MODULES (L=140 mm)
40 A	-	QM404013C	-
100 A	QM410007C	QM410011C	QM410015C
125 A	QM412507C	QM412511C	QM412515C

4-WAYS DISTRIBUTION BLOCK 160A

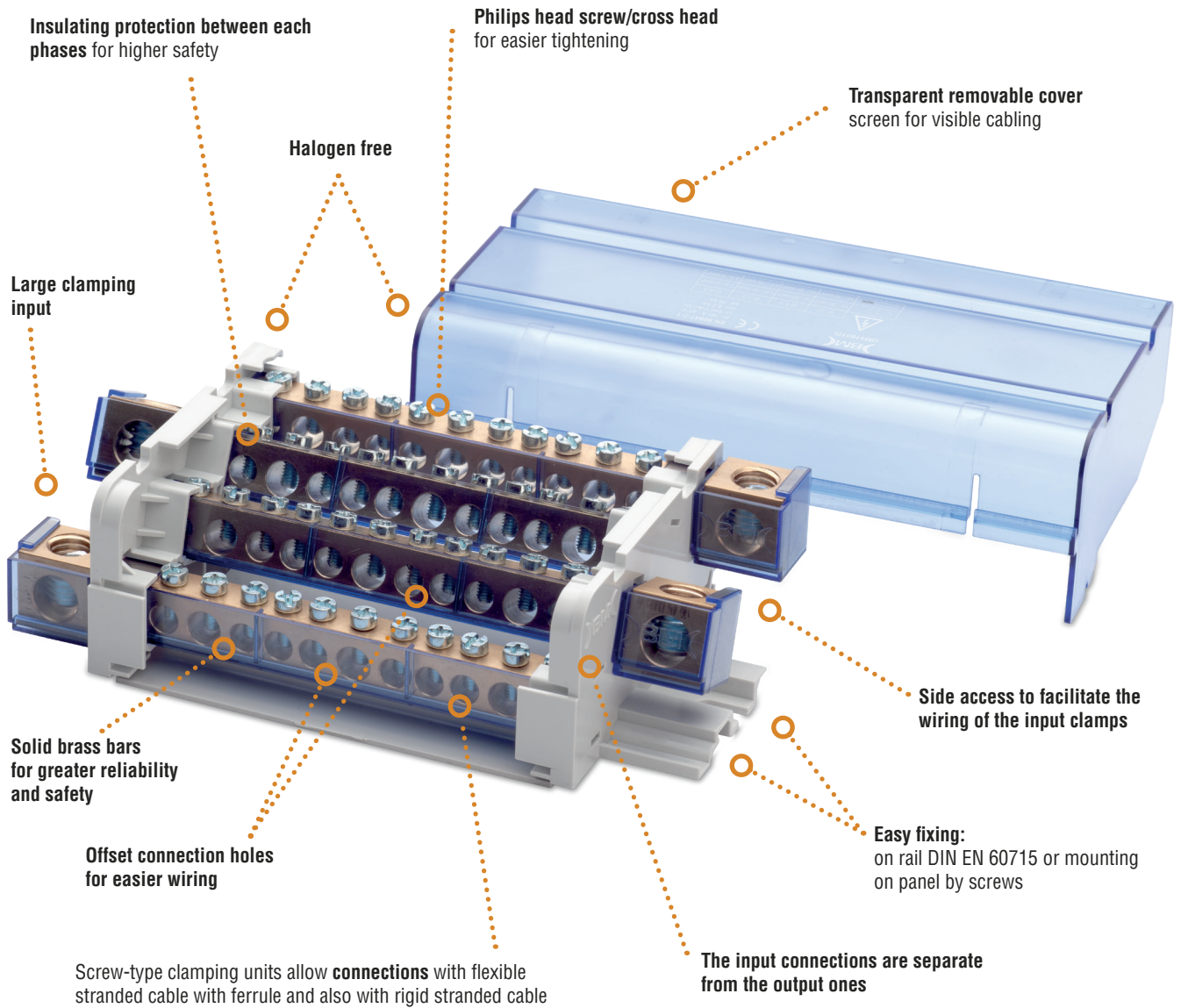

**HALOGEN
FREE**

Halogen free to install the distribution block everywhere



Solid brass bars with large clamping input for greater reliability and safety



Transparent cover screen for visible cabling



Compliant to harmonized standard IEC/EN 60947-7-1

DISTRIBUTION BLOCKS • MODULAR • 4-WAYS • 160A

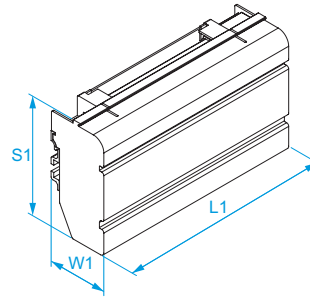
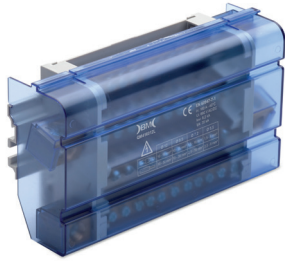

INSULATING HOUSING: polycarbonate (PC) UL 94 V0
INSULATED PROTECTIONS: polycarbonate (PC) UL 94 V0
CONNECTION BARS: brass
SCREWS: galvanized steel

INSULATION SELF-EXTINGUISHING: EN 60695-2-11 a 850 °C
AMBIENT TEMPERATURE: 40 °C
INSULATION VOLTAGE (Ui): 690 V
DEGREE OF POLLUTION: 3
ACCORDING TO STANDARD: IEC/EN 60947-7-1

Code	Rated Current (In)	Short-Time Current (Icw)	Peak Current (Ipk)	Connections for way	Flexible conductor with terminal	Rigid stranded conductor	Torque	L1	W1	S1	
	A	kA	kA	mm x N.	mm ²	mm ²	Nm	mm	mm	mm	
QM416012L	160	8.2	35	ø 12 x 1	10 - 50	10 - 50	8 - 10	175	50	98	1/1
				ø 8.5 x 3	10 - 25	10 - 35	2 - 3				
				ø 7.2 x 7	1.5 - 16	2.5 - 16	2 - 3				
				ø 5.5 x 1	1.5 - 6	2.5 - 6	2 - 3				



990271



BM SPA • Viale Milano 54/56 • 20089 Rozzano MI • Italy
 Tel. +39 02 8923911 r.a. • Fax +39 02 8256873
www.bm-group.com • info@bm-group.com

